

# TAPÓN CAPA

## CÉDULA STD

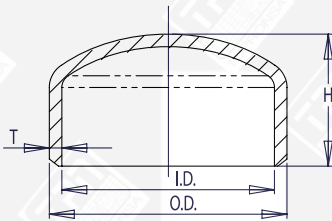

Tamaño del tubo	Diámetro exterior	Diámetro interior	Espesor de la pared	Alto	Nro. de cédula del tubo	Peso aprox. en kilogramos
NPS	O.D.	I.D.	T	H		
½	21.3	15.76	2.77	25	40	0.04
¾	26.7	20.96	2.87	25	40	0.06
1	33.4	26.64	3.38	38	40	0.10
1 ¼	42.2	35.08	3.56	38	40	0.15
1 ½	48.3	40.94	3.68	38	40	0.24
2	60.3	52.48	3.91	38	40	0.36
2 ½	73.0	62.68	5.16	38	40	0.45
3	88.9	77.92	5.49	51	40	0.77
3 ½	101.6	90.12	5.74	64	40	1.04
4	114.3	102.26	6.02	64	40	1.27
5	141.3	128.20	6.55	76	40	2.09
6	168.3	154.08	7.11	89	40	3.13
8	219.1	202.74	8.18	102	40	5.35
10	273.0	254.46	9.27	127	40	9.43
12	323.8	304.74	9.53	152	*	13.74
14	355.6	336.54	9.53	165	30	16.56
16	406.4	387.34	9.53	178	30	19.73
18	457.0	437.94	9.53	203	*	25.85
20	508.0	488.94	9.53	229	20	34.34
24	610.0	590.94	9.53	267	20	45.81
30	762.0	742.94	9.53	267	*	62.14
36	914.0	894.94	9.53	267	*	79.38
42	1067.0	1047.94	9.53	305	*	103.87
48	1219.0	1199.94	9.53	343	*	158.76

## CÉDULA XS

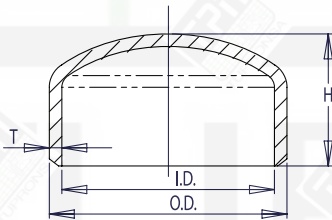

Tamaño del tubo	Diámetro exterior	Diámetro interior	Espesor de la pared	Alto	Nro. de cédula del tubo	Peso aprox. en kilogramos
NPS	O.D.	I.D.	T	H		
½	21.3	13.84	3.73	25	80	0.05
¾	26.7	18.88	3.91	25	80	0.07
1	33.4	24.30	4.55	38	80	0.13
1 ¼	42.2	32.50	4.85	38	80	0.22
1 ½	48.3	38.14	5.08	38	80	0.30
2	60.3	49.22	5.54	38	80	0.42
2 ½	73.0	58.98	7.01	38	80	0.59
3	88.9	73.66	7.62	51	80	0.95
3 ½	101.6	85.44	8.08	64	80	1.36
4	114.3	97.18	8.56	64	80	1.59
5	141.3	122.24	9.53	76	80	2.63
6	168.3	146.36	10.97	89	80	4.22
8	219.1	193.70	12.70	102	80	7.26
10	273.0	247.60	12.70	127	60	11.79
12	323.8	298.40	12.70	152	*	17.24
14	355.6	330.20	12.70	165	*	21.32
16	406.4	381.00	12.70	178	40	25.85
18	457.0	431.60	12.70	203	*	35.38
20	508.0	482.60	12.70	229	30	45.36
24	610.0	584.60	12.70	267	*	65.77
30	762.0	736.60	12.70	267	20	287.58
36	914.0	888.60	12.70	267	20	414.13
42	1067.0	1041.60	12.70	305	*	589.67
48	1219.0	1193.60	12.70	343	*	759.76

# TAPÓN CAPA

## CÉDULA 40

Tamaño del tubo	Diámetro exterior	Diámetro interior	Espesor de la pared	Alto	Nro. de cédula del tubo	Peso aprox. en kilogramos
NPS	O.D.	I.D.	T	H		
½	21.3	15.76	2.77	25	40	0.04
¾	26.7	20.96	2.87	25	40	0.06
1	33.4	26.64	3.38	38	40	0.10
1 ¼	42.2	35.08	3.56	38	40	0.15
1 ½	48.3	40.94	3.68	38	40	0.24
2	60.3	52.48	3.91	38	40	0.36
2 ½	73.0	62.68	5.16	38	40	0.45
3	88.9	77.92	5.49	51	40	0.77
3 ½	101.6	90.12	5.74	64	40	1.04
4	114.3	102.26	6.02	64	40	1.27
5	141.3	128.20	6.55	76	40	2.09
6	168.3	154.08	7.11	89	40	3.13
8	219.1	202.74	8.18	102	40	5.35
10	273.0	254.46	9.27	127	40	9.43
12	323.8	303.18	10.31	152	40	13.74
14	355.6	333.34	11.13	165	40	16.56
16	406.4	381.00	12.70	178	40	19.73
18	457.0	428.46	14.27	203	40	25.85
20	508.0	477.82	15.09	229	40	34.34
24	610.0	575.04	17.48	267	40	45.81

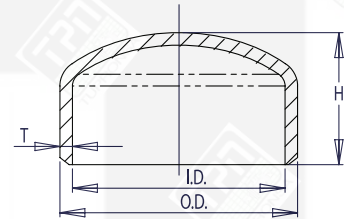

## CÉDULA 80

Tamaño del tubo	Diámetro exterior	Diámetro interior	Espesor de la pared	Alto	Nro. de cédula del tubo	Peso aprox. en kilogramos
NPS	O.D.	I.D.	T	H		
½	21.3	13.84	3.73	25	80	0.05
¾	26.7	18.88	3.91	25	80	0.07
1	33.4	24.30	4.55	38	80	0.13
1 ¼	42.2	32.50	4.85	38	80	0.22
1 ½	48.3	38.14	5.08	38	80	0.30
2	60.3	49.22	5.54	38	80	0.42
2 ½	73.0	58.98	7.01	38	80	0.59
3	88.9	73.66	7.62	51	80	0.95
3 ½	101.6	85.44	8.08	64	80	1.36
4	114.3	97.18	8.56	64	80	1.59
5	141.3	122.24	9.53	76	80	2.63
6	168.3	146.36	10.97	89	80	4.22
8	219.1	193.70	12.70	102	80	7.26
10	273.0	242.82	15.09	127	80	11.79
12	323.8	288.84	17.48	152	80	17.24
14	355.6	317.50	19.05	165	80	21.32
16	406.4	363.52	21.44	178	80	25.85
18	457.0	409.34	23.83	203	80	35.38
20	508.0	455.62	26.19	229	80	45.36
24	610.0	548.08	30.96	267	80	65.77

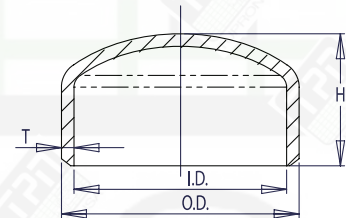

# TAPÓN CAPA

## CÉDULA 160

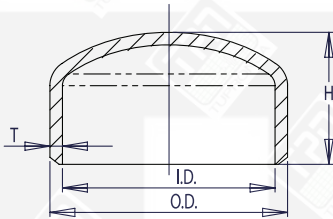

Tamaño del tubo	Diámetro exterior	Diámetro interior	Espesor de la pared	Alto	Nro. de cédula del tubo	Peso aprox. en kilogramos
NPS	O.D.	I.D.	T	H		
1/2	21.3	11.74	4.78	25	160	0.14
3/4	26.7	15.58	5.56	25	160	0.14
1	33.4	20.70	6.35	38	160	0.18
1 1/4	42.2	29.50	6.35	38	160	0.23
1 1/2	48.3	34.02	7.14	38	160	0.27
2	60.3	42.82	8.74	38	160	0.59
2 1/2	73.0	53.94	9.53	38	160	0.82
3	88.9	66.64	11.13	51	160	1.32
4	114.3	87.32	13.49	64	160	2.68
5	141.3	109.54	15.88	76	160	4.54
6	168.3	131.78	18.26	89	160	6.80
8	219.1	173.08	23.01	102	160	14.06
10	273.0	215.84	28.58	127	160	25.85
12	323.8	257.16	33.32	152	160	43.09
14	355.6	284.18	35.71	165	160	90.72
16	406.4	325.42	40.49	178	160	134.72
18	457.0	366.52	45.24	203	160	163.29
20	508.0	407.98	50.01	229	160	190.51
24	610.0	490.92	59.54	267	160	242.67

## CÉDULA XXS

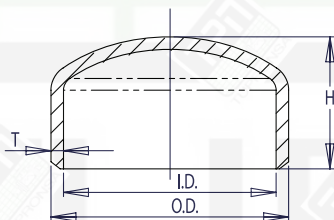

Tamaño del tubo	Diámetro exterior	Diámetro interior	Espesor de la pared	Alto	Nro. de cédula del tubo	Peso aprox. en kilogramos
NPS	O.D.	I.D.	T	H		
1/2	21.3	6.36	7.47	25	*	0.23
3/4	26.7	11.06	7.82	25	*	0.34
1	33.4	15.22	9.09	38	*	0.45
1 1/4	42.2	22.80	9.70	38	*	0.68
1 1/2	48.3	28.00	10.15	38	*	1.13
2	60.3	38.16	11.07	38	*	1.36
2 1/2	73.0	44.96	14.02	38	*	1.81
3	88.9	58.42	15.24	51	*	2.72
4	114.3	80.06	17.12	64	*	4.08
5	141.3	103.20	19.05	76	*	6.12
6	168.3	124.40	21.95	89	*	8.16
8	219.1	174.64	22.23	102	*	11.79
10	273.0	222.20	25.40	127	140	20.87
12	323.8	273.00	25.40	152	120	30.84